

imageRUNNER ADVANCE DX 6800 Series

SECURE, SUSTAINABLE A3 MONO MULTIFUNCTION DEVICES WITH INTEGRATED CLOUD-BASED SOFTWARE TO EXPEDITE PRINTING AND DOCUMENT DIGITISATION

MAIN CONFIGURATION OPTIONS



Canon uniFLOW Online
Outstanding Cloud Output Management Solution



Canon uniFLOW Online
Outstanding Cloud Output Management Solution



New to the Line

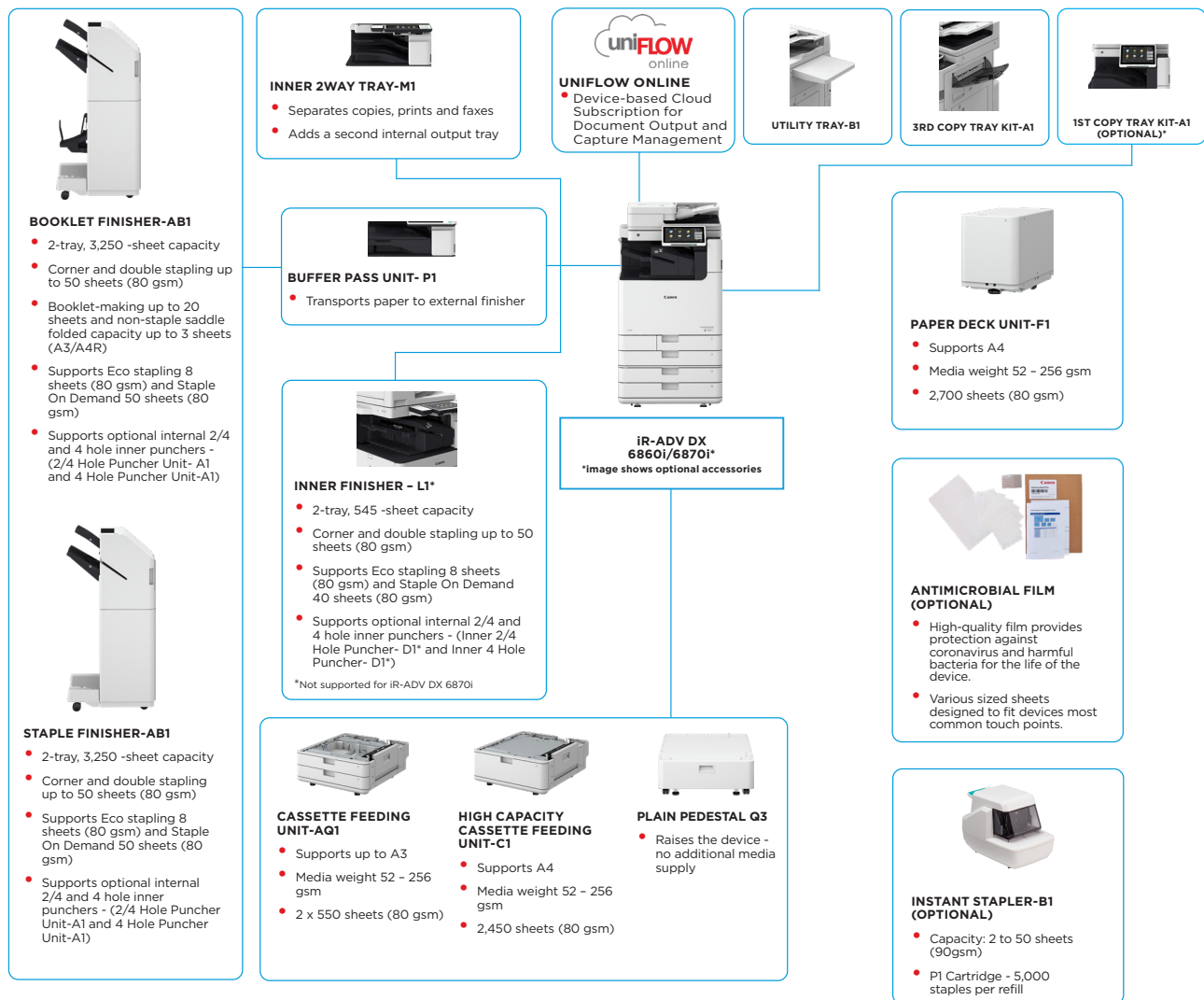

This flat configuration is for illustration purpose only. For a complete list of options and the exact compatibility relationships, please refer to the online [product configurator](#).

The Unified Firmware Platform (UFP) ensures that the latest feature upgrades and protection are available, for an enhanced user experience across the entire iR ADVANCE DX portfolio.

*To support sustainability and save on raw materials required for plastics, 1st Copy Tray Kit-A1 is optional.



TECHNICAL SPECIFICATIONS

imageRUNNER ADVANCE DX 6800 Series

MAIN UNIT

Machine type
Core functions
Processor
Control Panel
Memory
Storage
Interface Connection
Paper Supply Capacity (A4, 80gsm)
Paper output capacity (A4, 80gsm)
Finishing capabilities
Supported Media Types
Supported Media Sizes
Supported media weights
Warm-up Time
Dimensions (W x D x H)
Installation Space(W x D)
Weight*
PRINT SPECIFICATIONS
Print Speed (BW)
Print Resolution (dpi)
Page description languages
Direct Print
Printing from mobile and cloud
Fonts

A3 Monochrome Laser Multifunctional
 Print, Copy, Scan, Send, Store and Optional Fax
 1.8GHz Dual Core Processor
 10.1" TFT LCD WSVGA Color Touch panel
 Standard: 5.0GB RAM
 Standard: (SSD) 256GB, Optional: (SSD) 1TB
NETWORK
 Standard: 1000Base-T/100Base-TX/10Base-T, Wireless LAN (IEEE 802.11 b/g/n);
 Optional: NFC, Bluetooth Low Energy
OTHERS
 Standard: USB 2.0 (Host) x1, USB 3.0 (Host) x1, USB 2.0 (Device) x1;
 Optional: Serial Interface, Copy Control Interface
 Standard: 1200 sheets
 100-sheet multi-purpose tray x 1
 550-sheet cassettes x 2
 Maximum: 6,350 sheets (with High Capacity Cassette Feeding Unit-C1 + Paper Deck Unit-F1)
 Maximum: 3,450 Sheets (with Staple Finisher-AB1 or Booklet Finisher-AB1 and 3rd Copy Tray Kit-A1)
 Collate, Group, Offset, Staple, Saddle Stitch, Hole Punch, Eco Staple, Staple On Demand
 * Finishing capabilities vary depending on the options connected.
Multi-purpose tray:
 Thin, Plain, Recycled, Color, Heavy, Coated, Tracing, Bond, Transparency, Label, Pre-punched, Letterhead, Tab, Envelope
Paper Cassette (Upper/Lower):
 Thin, Plain, Recycled, Color, Heavy, Bond, Transparency, Pre-punched, Letterhead, Envelope*
 * Envelope Feeder Attachment (standard) is required.
Multi-purpose tray:
 Standard size: SRA3, A3, A4, A4R, A5, A5R, A6R, B4, B5, B5R
 Custom size: 98.0 x 139.7 mm to 320.0 x 457.2 mm
 Free Size: 98.0 x 139.7 mm to 320.0 x 457.2 mm
 Envelopes: COM10 No.10, Monarch, DL, ISO-C5
 Envelope custom size: 98.0 x 90.0 mm to 320.0 x 457.2 mm
Upper Cassette:
 Standard size: A4, A5, A5R, A6R, B5
 Custom Size: 98.0 x 148.0 mm to 297.0 x 215.9 mm
 Envelopes: COM10 No.10, Monarch, DL, ISO-C5
Lower Cassette:
 Standard size: A3, A4, A4R, A5, A5R, A6R, B4, B5, B5R
 Custom size: 98.0 x 148.0 mm to 304.8 x 457.2 mm
 Envelopes: COM10 No.10, Monarch, DL, ISO-C5
 Multi-purpose tray: 52 to 300 gsm
 Paper Cassettes (Upper/Lower): 52 to 256 gsm
 Duplex: 52 to 256 gsm
 Quick Startup Mode: 4 Seconds or less*
 * Time from device power-on to when the copy icon appears and is enabled to operate on the touch panel display.
From Sleep Mode:
 7 Seconds or Less (iR-ADV DX 6870i)
 6 Seconds or Less (iR-ADV DX 6860i)
From Power On: 6 Seconds or less*
 * Time from device power-on, until copy ready (not print reservation).
 620 x 722 x 937 mm
 Basic: 1138 x 1162 mm (Right Cover Open with Multi-purpose tray extended + Cassette Drawers Open)
 Fully Configured: 1866 x 1162 mm (Staple Finisher-AB1/Booklet Finisher-AB1 with the extension tray extended + Paper Deck Unit-F1 + Cassette Drawers open)
 iR-ADV DX 6870i: Approx. 93 kg
 iR-ADV DX 6860i: Approx. 91 kg
 iR-ADV DX 6870i
 up to 70 ppm (A4, A5*, A5R, A6R*), up to 36 ppm (A3), up to 42 ppm (A4R)
 iR-ADV DX 6860i
 up to 60 ppm (A4, A5*, A5R, A6R*), up to 32 ppm (A3), up to 36 ppm (A4R)
 * 1-sided only
 1,200 x 1,200
 Standard: UFR II, PCL6
 Optional: Adobe® PostScript®3™
 Supported file types: PDF, EPS, TIFF/JPEG, and XPS
 AirPrint, Mopria, Universal Print by Microsoft, Canon PRINT Business App, and uniFLOW Online (optional)
 A range of software and MEAP-based solutions are available to provide printing from mobile devices or internet-connected devices and cloud-based services depending on your requirements.
 Please contact your sales representative for further information.
 PS fonts: 136 Roman
 PCL fonts: 93 Roman, 10 Bitmap fonts, 2 OCR fonts, Andale Mono WT J/K/S/T¹
 (Japanese, Korean, Simplified and Traditional Chinese), Barcode fonts²

¹ Optional PCL International Font Set-A1 is required.
² Optional Barcode Printing Kit-D1 is required.

Print Features

Operating System

COPY SPECIFICATIONS

Copy Speed (BW)

First-Copy-Out Time (A4, BW)

Copy resolution (dpi)

Multiple Copies

Copy Density

Magnification

Copy Features

SCAN SPECIFICATION

Type

Document Feeder Paper Capacity (80 gsm)

Acceptable Originals and weights

Supported media sizes

Scan Speed (ipm: BW/CL; A4)

Scan Resolution (dpi)

Pull Scan Specifications

Scan Method

SEND SPECIFICATIONS

Destination

Address Book

Send resolution (dpi)

Communication protocol

File Format

Universal Send Features

Secured Print, Secure Watermark, Header/Footer, Page Layout, Two-sided Printing, Mixed Paper Sizes/ Orientations, Front/Back Covers, Toner Reduction, Poster Printing, Forced Hold printing, Print Date, Scheduled Printing, Printing Using a Virtual Printer
 UFR II: Windows® 8.1/10/Server2012/Server2012 R2/ Server2016/Server2019, Mac OS X(10.11 or later)
 PCL: Windows® 8.1/10/Server2012/Server2012 R2/ Server2016/Server2019
 PS: Windows® 8.1/10/Server2012/Server2012 R2/ Server2016/Server2019, Mac OS X(10.11 or later)
 PPD: Windows® 8.1/10, Mac OS X(10.11 or later)
 McAfee Embedded Control
 As of Oct. 2020
 iR-ADV DX 6870i
 up to 70 ppm (A4, A5*, A5R, A6R*), up to 36 ppm (A3), up to 42 ppm (A4R)
 iR-ADV DX 6860i
 up to 60 ppm (A4, A5*, A5R, A6R*), up to 32 ppm (A3), up to 36 ppm (A4R)
 * 1-sided only
 iR-ADV DX 6870i: Approx. 2.7 seconds or less
 iR-ADV DX 6860i: Approx. 2.9 seconds or less
 600 x 600
 Up to 9,999 copies
 Automatic or Manual (9 Levels)
 Variable zoom: 25% to 400% (1% Increments)
 Preset reduction/enlargement: 25%, 50%, 70%, 100%(1:1), 141%, 200%, 400%
 Preset R/E Ratios by Area, Two-Sided, Density Adjustment, Original Type Selection, Interrupt Mode, Book to Two Pages, Two-sided Original, Job Build, N on 1, Add Cover, Insert Sheets, Different Size Originals, Page Numbering, Copy Set Numbering, Sharpness, Erase Frame, Secure Watermark, Print Date, Gutter, Print & Check, Negative/Positive, Repeat Images, Merge Job Blocks, Mirror Image, Store in Mail Box, Superimpose Image, Copy ID Card, Skip Blank Pages, Free Size Original, Reserved copy, Copy Sample
 Single-pass Duplexing Automatic Document Feeder*
 [2-sided to 2-sided (Automatic)]
 * Detect Feeder Multi Sheet Feed is supported.
 up to 200 Sheets
 Platen: Sheet, Book, and 3-Dimensional Objects
 Document Feeder media weight:
 1-sided scanning: 38 to 220 gsm
 2-sided scanning: 38 to 220 gsm
 * An acceptable weights of A6R or smaller is 50 to 220gsm.
 Platen scanning size: up to 297.0 x 431.8 mm
 Document Feeder media size:
 A3, A4, A4R, A5, A5R, A6R, B4, B5, B5R, B6R
 Custom size: 70.0 x 139.7 mm to 304.8 x 431.8 mm
 1-sided Scanning: 135/135 (300 x 300 dpi, send), 80/80 (600 x 600 dpi, copy),
 2-sided Scanning: 270/270 (300 x 300 dpi, send), 160/90 (600 x 600 dpi, copy)
 Scan for Copy: 600 x 600
 Scan for Send: (Push) 600 x 600 (SMB/FTP/WebDAV/IFAX), (Pull) 600 x 600
 Scan for Fax: 600 x 600
 Color Network ScanGear2. For both TWAIN and WIA
 Supported OS: Windows® 8.1/10/Server2012/Server2012 R2/Server 2016
 As of Mar. 2020
 Push Scan, Pull Scan, Scan to Box, Scan to Advanced Space, Scan to Network, Scan to USB Memory Key, Scan to Mobile devices, Scan to cloud (uniFLOW Online - Optional)
 Standard: E-mail/Internet FAX (SMTP), SMB3.0, FTP, FTPS WebDAV, Mail Box
 Optional: Super G3 FAX, IP Fax
 LDAP (2,000)/Local (1,600)/Speed dial (200)
 Push: up to 600 x 600
 Pull: up to 600 x 600
 File: FTP(TCP/IP), SMB3.0 (TCP/IP), WebDAV
 E-mail/Fax: SMTP, POP3
 TIFF, JPEG, PDF(Compact, Searchable, Apply policy, Optimize for Web, PDF/A-1b, Trace & Smooth, Encrypted, Device Signature, User Signature), XPS(Compact, Searchable, Device Signature, User Signature), Office Open XML (PowerPoint, Word)
 Original Type Selection, Two-sided Original, Book to Two Pages, Different-size Originals, Density Adjustment, Sharpness, Copy Ratio, Erase Frame, Job Build, Delayed Send, Preview, Job Done Notice, File Name, Subject/Message, Reply-to, E-mail Priority, TX Report, Original Content Orientation, Skip Blank Pages



TECHNICAL SPECIFICATIONS

imageRUNNER ADVANCE DX 6800 Series

FAX SPECIFICATIONS

Maximum Number of Connection Lines	1
Modem Speed	Super G3: 33.6 kbps G3: 14.4 kbps
Compression Method	MH, MR, MMR, JBIG
Resolution (dpi)	400 x 400 (Ultra Fine), 200 x 400 (Super Fine), 200 x 200 (Fine), 200 x 100 (Normal)
Sending/Receiving Size	Sending: A3, A4, A4R, A5 ¹ , A5R ¹ , B4, B5 ² , B5R ¹ Receiving: A3, B4, A4, A4R, A5R, B5, B5R ¹ Sent as A4 ² Sent as B4 short
FAX memory	Up to 30,000 pages (2,000 jobs)
Speed dials	Max. 200
Group dials/destinations	Max. 199 dials
Sequential broadcast	Max. 256 addresses
Memory backup	Yes
Fax Features	Sender's Name (TTI), Selecting the Telephone Line (when sending fax), Direct Send, Delayed Send, Preview, Job Done Notice, TX Report, Interrupt Transmission, Sequential Broadcasting, Password/Subaddress Sending, Confidential Mailbox, 2 on 1 Log

STORE SPECIFICATIONS

Mail Box (Number supported)	100 User Inboxes, 1 Memory RX Inbox, 50 Confidential Fax Inboxes Maximum 30,000 Pages (2,000 jobs) Stored
Advanced Space	Communication Protocol: SMB or WebDAV Supported Client PC: Windows® 8.1/10 Concurrent Connections (Max.): SMB:64, WebDAV:3
Advanced Space available disc space	Standard:16 GB (With option: max. 480GB)
Advanced Space Features:	Authentication for Advanced Space Log-in, Sort Function, Printing a PDF File with a Password, imageWARE Secure Audit Manager Support, Search, File Preview, Authentication Management, Open to public, URI TX, Backup/Restore

SECURITY SPECIFICATIONS

Authentication and Access Control	User Authentication (Picture Login, Picture and PIN Login, Card Login*, Username and Password Login, Function Level Login, Mobile Login), Department ID Authentication (Department ID and PIN Login, Function Level Login), uniFLOW Online Express (PIN Login, Picture Login, Picture and PIN Login, Card Login, Card and PIN Login, Username and Password Login, Department ID and PIN Login, Function Level Login), Access Management System (Access Control) * Card readers are optional, please refer to Hardware Accessories Activation is required
Document Security	Print Security (Secure Print, Encrypted Secure Print, Forced Hold Printing, uniFLOW Secure Print*), Receive Data Security (Confidential Fax Inbox Forwarding Received Documents Automatically), Scan Security (Encrypted PDF, Device Signature PDF/XPS, User Signature PDF/XPS, Adobe LiveCycle® Rights Management ES2.5 Integration), BOX Security (Mail Box Password Protected, Advanced Space Access Control), Send Data Security (Setting for requesting password input per transmission, Restricted E-mail/File send functions, Confirming FAX number, Allow/Restrict Fax Driver Transmissions, Allow/Restrict Sending from History, S/MIME Support), Document Tracking (Secure Watermark) ¹ Requires uniFLOW Online / uniFLOW
Network Security	TLS 1.3, IPsec, IEEE802.1X authentication, SNMP V3.0, Firewall Functionality (IP/MAC Address Filtering), Dual Network Support (Wired LAN/Wireless LAN, Wired LAN/Wired LAN), Disabling Unused Functions (Enabling/Disabling Protocols/Applications, Enabling/Disabling Remote UI, Enabling/Disabling USB Interface), G3 FAX separation from LAN, USB Port separation from LAN, Prohibit the execution of files stored in Advanced Box in the MFP, Scan and Send -Virus Concerns for E-mail Reception
Device Security	Protecting SSD Data [SSD Data Encryption (FIPS140-2 Validated), SSD Lock], Standard SSD Initialize, Trusted Platform Module (TPM 2.0), Job Log Conceal Function, Protecting MFD Software Integrity, Checking MFD Software Integrity (Verify System at Startup, Runtime Intrusion Detection enabled with McAfee Embedded Control), HCD-PP* * Certification will follow post launch of this Series
Device Management and Auditing	Administrator Password, Digital Certificate And Key Management, Audit Log, Cooperating with External Security Audit System (Security Information and Event Management), Image Data Logging, Security Policy Setting

ENVIRONMENTAL SPECIFICATIONS

Operating Environment

Temperature: 10 to 30 °C
Humidity: 20 to 80 % RH (Relative Humidity)
220-240 V, 50/60 Hz, 6 A

Power source

Power consumption

Maximum:
iR-ADV DX 6870i: Approx. 2,000 W
iR-ADV DX 6860i: Approx. 1,800 W
Copying (with DADF continuous scan): Approx. 858 W¹
Standby: Approx. 50.7 W¹
Sleep mode: Approx. 0.8 W²

¹ Reference value: measured one unit
² 0.8 W is not available in all circumstances due to certain settings.

Typical Electricity Consumption (TEC):
iR-ADV DX 6870i: 0.85 kWh
iR-ADV DX 6860i: 0.71 kWh

* As per USA Energy Star 3.0

Sound Power Level (LWA_m)

Active (1-sided)
iR-ADV DX 6870i: 66 dB*, Kv 3 dB*
iR-ADV DX 6860i: 64 dB*, Kv 3 dB*

* Reference value: measured only one unit with ISO7779, described with ISO9296 (2017)

Sound Pressure (Lp_A_m)

Bystander's position:
Active (1-sided): 52 dB* (iR-ADV DX 6870i), 51 dB* (iR-ADV DX 6860i) Stand-by: 25 dB*

* Reference value: measured only one unit with ISO7779, described with ISO9296 (2017)

Blue Angel

Noise levels (BW)

Standards

CONSUMABLES

Toner Cartridges

Toner Yield (Estimated Yield @6% coverage)

C-EXV 61 Toner BK
C-EXV 61 Toner BK: 71,500 pages

SOFTWARE AND PRINTER MANAGEMENT

Tracking and reporting

For detailed information please visit our website
<https://www.canon-europe.com/business/>

Universal Login Manager (ULM)

[uniFLOW Online Express*](#)

* For more information, please refer to

[uniFLOW Online Express](#)

[uniFLOW Online](#)

Remote management tools

iW Management Console
eMaintenance
Content Delivery System

Scanning software

Optimisation tools

Platform

Document Publishing

Network ScanGear

Canon Driver Configuration Tool

MEAP (Multifunctional Embedded Application Platform)

Kofax PowerPDF Advanced (Optional)

PAPER SUPPLY OPTIONS

Cassette Feeding Unit-AQ1

Paper Capacity: 2 x 550 sheets (80 gsm)
Paper Type: Thin, Plain, Recycled, Color, Heavy, Bond, Transparency, Pre-punched, Letterhead
Paper Size: A3, A4, A4R, A5, A5R, A6R, B4, B5, B5R
Custom size: 98.0 x 148.0 mm to 304.8 x 457.2 mm
Paper Weight: 52 to 256 gsm
Dimensions (W x D x H): 620 x 660 x 251 mm (attached to the main unit)
Weight: Approx. 22 kg

High Capacity Cassette Feeding Unit-C1

Paper Capacity: 2,450 sheets (80 gsm)
Paper Type: Thin, Plain, Recycled, Color, Heavy, Bond, Pre-punched, Letterhead
Paper Size: A4
Paper Weight: 52 to 256 gsm
Dimensions (W x D x H): 620 x 660 x 251 mm (attached to the main unit)
Weight: Approx. 29 kg

Paper Deck Unit-F1

Paper Capacity: 2,700 sheets (80 gsm)
Paper Type: Thin, Plain, Color, Recycled, Heavy, Pre-punched
Paper Size: A4, B5
Paper Weight: 52 to 256 gsm
Dimensions (W x D x H): 344 x 630 x 440 mm (attached to the main unit)
Weight: Approx. 31 kg

TECHNICAL SPECIFICATIONS

imageRUNNER ADVANCE DX 6800 Series

OUTPUT OPTIONS*

1st Copy Tray Kit-A1

* Paper capacity may vary with different of paper type/size.

Capacity (with 80gsm paper):
A4, A5, A5R, A6R, B5: 250 sheets
SRA3, A3, A4R, B4, B5R: 100 sheets
Paper Weight: 52 to 300 gsm
Dimensions (W x D x H): 454 x 493 x 114 mm
Weight: 1.2 kg

Inner 2way Tray-M1

Tray Capacity (with 80 gsm paper)
Upper tray: A4, A5, A5R, A6R, B5: 100 sheets
SRA3, A3, A4R, B4, B5R: 50 sheets
Lower tray (1st Copy Tray Kit-A1): A4, A5, A5R, A6R, B5: 250 sheets
SRA3, A3, A4R, B4, B5R: 100 sheets
Paper Weight: 52 to 300 gsm
Dimensions (W x D x H): 428 x 405 x 88 mm
Weight: Approx. 0.7 kg

3rd Copy Tray Kit-A1

Capacity (with 80gsm paper):
A4, A5R, B5: 100 sheets
A3, A4R, B4, B5R: 75 sheets
Dimensions (W x D x H): 442 x 373 x 176 mm
(attached to the main unit, when the extension tray is extended)
Weight: 0.5 kg

Inner Finisher-L1

(Not supported for IR-ADV DX 6870i)

Tray Capacity (with 80gsm paper):
Upper Tray: SRA3, A3, A4, A4R, A5, A5R, A6R, B4, B5, B5R: approx. 45 sheets
Lower Tray: A4, A5, A5R, B5: approx. 500 sheets, SRA3, A3, A4R, B4, B5R: 250 sheets, A6R: 30 sheets
Envelope: 10 sheets
Paper Weight: 52 to 300 gsm
Staple Position: Corner, Double
Staple Capacity: (52 to 90 gsm paper)
A4, B5: 50 sheets
A4R: 40 sheets
A3, B4: 30 sheets
Eco Staple:
A3, A4, B4, B5: 10 sheets (52 to 64 gsm)
8 sheets (65 to 81.4 gsm)
6 sheets (82 to 105 gsm)

Staple On Demand: 40 sheets (80 gsm)
Dimensions (W x D x H): 743 x 525 x 225 mm
(attached to the main unit, when the extension tray is extended)
Weight: Approx. 9.1 kg

Staple Finisher-AB1

(Requires Buffer Pass Unit-P1)
Tray Capacity (with 80gsm paper):
Upper Tray: A4, A5, A5R, A6R, B5: approx. 250 sheets, SRA3, A3, A4R, B4, B5R: approx. 125 sheets
Lower Tray: A4, A5, A5R, B5: 3,000 sheets, SRA3, A3, A4R, B4, B5R: 1,500 sheets, A6R: 250 sheets
Envelopes: Monarch: 30 sheets, COM10 No.10, DL, ISO-C5: 100 sheets
Paper Weight:
Upper Tray 52 to 256 gsm,
Lower Tray 52 to 300 gsm
Staple Position: Corner, Double
Staple Capacity: (52 to 90 gsm)
A4, B5: 50 sheets
A4R: 40 sheets
A3, B4: 30 sheets
Eco Staple:
A3, A4: 10 sheets (52 to 64 gsm)
8 sheets (65 to 81.4 gsm)
6 sheets (82 to 105 gsm)
Staple On Demand: 50 sheets (52 to 90 gsm)
Dimensions (W x D x H): 637 x 623 x 1,142 mm
(when the extension tray is extended)
Weight: Approx. 31 kg

Booklet Finisher-AB1

(Requires Buffer Pass Unit-P1)
(Includes the above Staple Finisher-AB1 basic staple specifications.)
Saddle Stitch paper size: A3, A4R, B4
Saddle Stitch Staple Capacity: 20 sheets x 10 sets (52 to 81.4 gsm) (including 1 cover sheet 52 to 256 gsm)
Non Staple Folded Bunch Capacity: up to 3 sheets (52 to 105 gsm)
Dimensions (W x D x H): 637 x 623 x 1,142 mm
(when the extension tray is extended)
Weight: Approx. 57 kg

Inner 2/4 Hole Puncher-D1

(Not supported for IR-ADV DX 6870i)

(Requires the Inner Finisher-L1)
Two or Four Holes
Acceptable Punch Paper Weight: 52 to 300 gsm
Acceptable Punch Paper Size:
Two holes: A3, A4, A4R, A5, B4, B5, B5R
Four holes: A3, A4

Inner 4 Hole Puncher-D1

(Not supported for IR-ADV DX 6870i)

(Requires the Inner Finisher-L1)
Four Holes
Acceptable Punch Paper Weight: 52 to 300 gsm
Acceptable Punch Paper Size:
Four holes: A3, A4, A4R, A5, B4, B5, B5R

2/4 Hole Puncher Unit-A1

(Requires either the Staple Finisher-AB1 or Booklet Finisher-AB1)
Two or Four Holes
Acceptable Punch Paper Weight: 52 to 300 gsm
Acceptable Punch Paper Size:
Two holes: A3, A4, A4R, A5, B4, B5, B5R
Four holes: A3, A4

4 Hole Puncher Unit-A1

(Requires either the Staple Finisher-AB1 or Booklet Finisher-AB1)
Four Holes
Acceptable Punch Paper Weight: 52 to 300 gsm
Acceptable Punch Paper Size:
Four holes A3, A4, A4R, A5, B4, B5, B5R

HARDWARE ACCESSORIES

Card Readers

Various card readers available e.g. MiCard Plus. Please contact local Canon Office for more details
Copy Card Reader Attachment-B7
Copy Card Reader-F1
IC Card Reader Box for Numeric Keypad-A1

Others

Printer Cover-M2
Tab Feeding Attachment-F1
Buffer Pass Unit-P1
Utility Tray-B1
Numeric Keypad-A2
Instant Stapler-B1 (optional)

SECURITY OPTIONS

Data Security

250GB SSD-A1 (usage with Memory Mirroring Kit-A1)
1TB SSD-A1
Memory Mirroring Kit-A1

SYSTEM AND CONTROLLER OPTIONS

Print Accessories

PCL International Font Set-A1
PS Printer Kit-BC1

Barcode Printing

Barcode Printing Kit-D1

System Accessories

Copy Control Interface Kit-A1
Serial Interface Kit-K3
Connection Kit-A3 for Bluetooth LE
NFC Kit-E2

Fax Accessories

Super G3 FAX Board-AX1
Remote Fax Kit-A1
IP FAX Expansion Kit-B1

OTHER OPTIONS

Accessibility Accessories

ADF Access Handle-A1
Voice Guidance Kit-G1
Voice Operation Kit-D1

Consumables

Staple-P1 (2 x 5,000pcs)
Staple Cartridge-Y1 (2 x 2,000pcs)*
* For Booklet Finisher only

Device Protection

Antimicrobial Film* - Various Sheets designed to fit the devices most common touch points.
*Application by a Service engineer is recommended

Software & Solutions



Certifications and compatibility



Canon Ireland
3006 Lake Drive
Citywest, Saggart
Co. Dublin, Ireland
Telephone No: 01 2052400
Facsimile No: 01 2052525
canon.ie

Canon (UK) Ltd
5 The Square
Stockley Park
Uxbridge
UB11 1ET
Tel: 01895 648 000
www.canon.co.uk

Canon Inc.
canon.com
Canon Europe
canon-europe.com
English edition
© Canon Europa N.V., 2021

